

5RAFB6D6

Low Leakage Control Damper

Extruded Aluminum

RELIABLE

APPLICATION

The 5RAFB6D6 is a low leak, extruded aluminum damper designed with airfoil blades for higher velocity and pressure HVAC systems. It meets the leakage requirements of the International Energy Conservation Code by leaking less than 3 cfm/sq. ft. at 1" of static pressure.

STANDARD CONSTRUCTION

Frame	5" x 1" (127 x 25) x 6063T5 extruded aluminum hat channel with .125" (3.2) minimum wall thickness. Low profile, 5" x 1/2" (127 x 13) top and bottom frames on dampers 12" (305) high and less. Mounting flanges on both sides of frame.
Blades	6" (152) wide, 6063T5 heavy gage extruded aluminum, airfoil shaped blades.
Linkage	Concealed.
Axles	1/2 " (13) plated steel hex.
Bearings	Molded synthetic.
Seals	Extruded TPR blade edge seal for -72°F to +275°F (-58°C to +135°C) and flexible metal compression type jamb seals.
Control Shaft	6" x 1/2" (152 x 13) diameter. Outboard support bearing supplied with all single section dampers for field mounted actuators. Factory-installed jackshaft supplied with all multiple section dampers.
Finish	Mill.
Minimum Size	Single blade, parallel action – 6"w x 5"h (152 x 127). Two blade, parallel or opposed action – 6"w x 9"h (152 x 229).
Maximum Size	Single section – 60"w x 72"h (1524 x 1829). Multiple section assembly – Unlimited size.

FEATURES

- Airfoil blade design for low pressure drop and less noise generation.
- Positive lock axles, noncorrosive bearings and shake proof linkage for low maintenance operation.
- Blade edge seals mechanically lock into the blade for superior sealing.

Note:

- Dimensions shown in inches, parenthesis () indicate millimeters.
- *Units furnished approximately 1/4" (6) smaller than given opening dimensions.
- **Jackshaft used only on multiple section dampers.

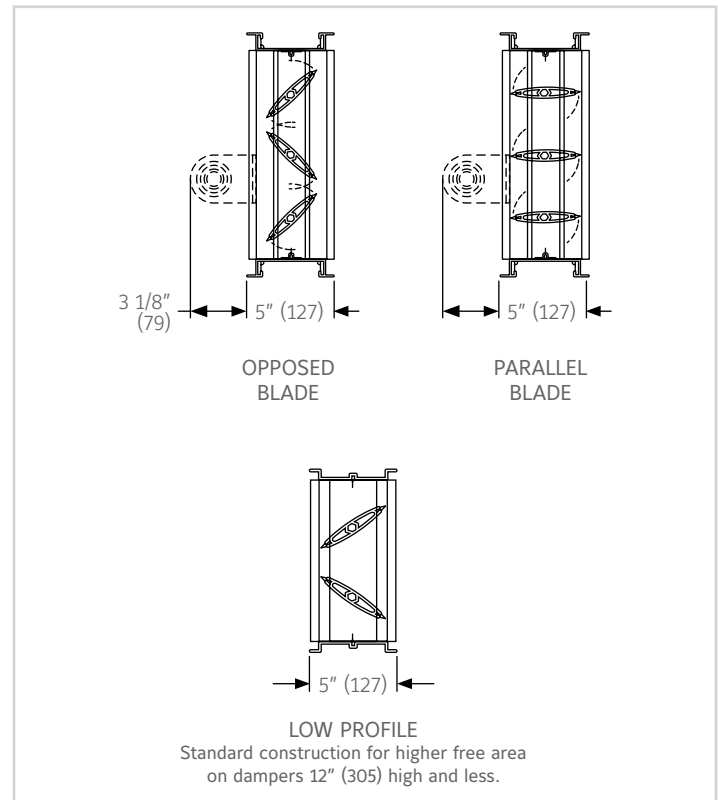

VARIATIONS

Variations to the 5RAFB6D6 standard design are available at additional cost and include:

- Anodize finishes.
- Factory-installed, pneumatic and electric actuators (specific information required with order).
- Frame-mounting bracket for simple field installation of most actuators.
- SP100 Switch Package to remotely indicate damper blade position.
- Front or rear flange frame.
- Face and bypass mixing damper assemblies.

SUGGESTED SPECIFICATION

Furnish and install, at locations shown on plans, or in accordance with schedules, low leakage dampers that meet the following minimum construction standards: Frames shall be 5" x 1" x .0125" (127 x 25 x 3.2) (minimum thickness) 6063T5 extruded aluminum hat channel with hat mounting flanges on both sides of the frame. Each corner shall be reinforced with two die formed internal braces and machine staked for maximum rigidity. Blades shall be airfoil type extruded aluminum (maximum 6" (152) depth) with integral structural reinforcing tube running full length of each blade.

Blade edge seals shall be extruded TPR double edge design with inflatable pocket which enables air pressure from either direction to assist in blade to blade seal off. Blades seals shall be mechanically locked in extruded blade slots, yet shall be easily replaceable in field. Adhesive or clip-on type blade seals are not acceptable. Bearings shall be non-corrosive molded synthetic. Axles shall be hexagonal (round not acceptable) to provide positive locking connection to blades and linkage. Linkage shall be concealed in frame. Dampers shall be in all respects equivalent to Reliable Model 5RAFBCD6.

LINKS TO IMPORTANT DOCUMENTS

Document Title
Finishes and Color Guide
Limited Warranty Document



1300 Enterprise Road, P.O. Box
580, Geneva, Alabama 36340
Tel: 334-684-3621
Tel: 800-624-3914
Fax: 800-508-1469